

# INSTALLATION INSTRUCTION

6142/S Satin nickel no shade ( D180xH274mm)

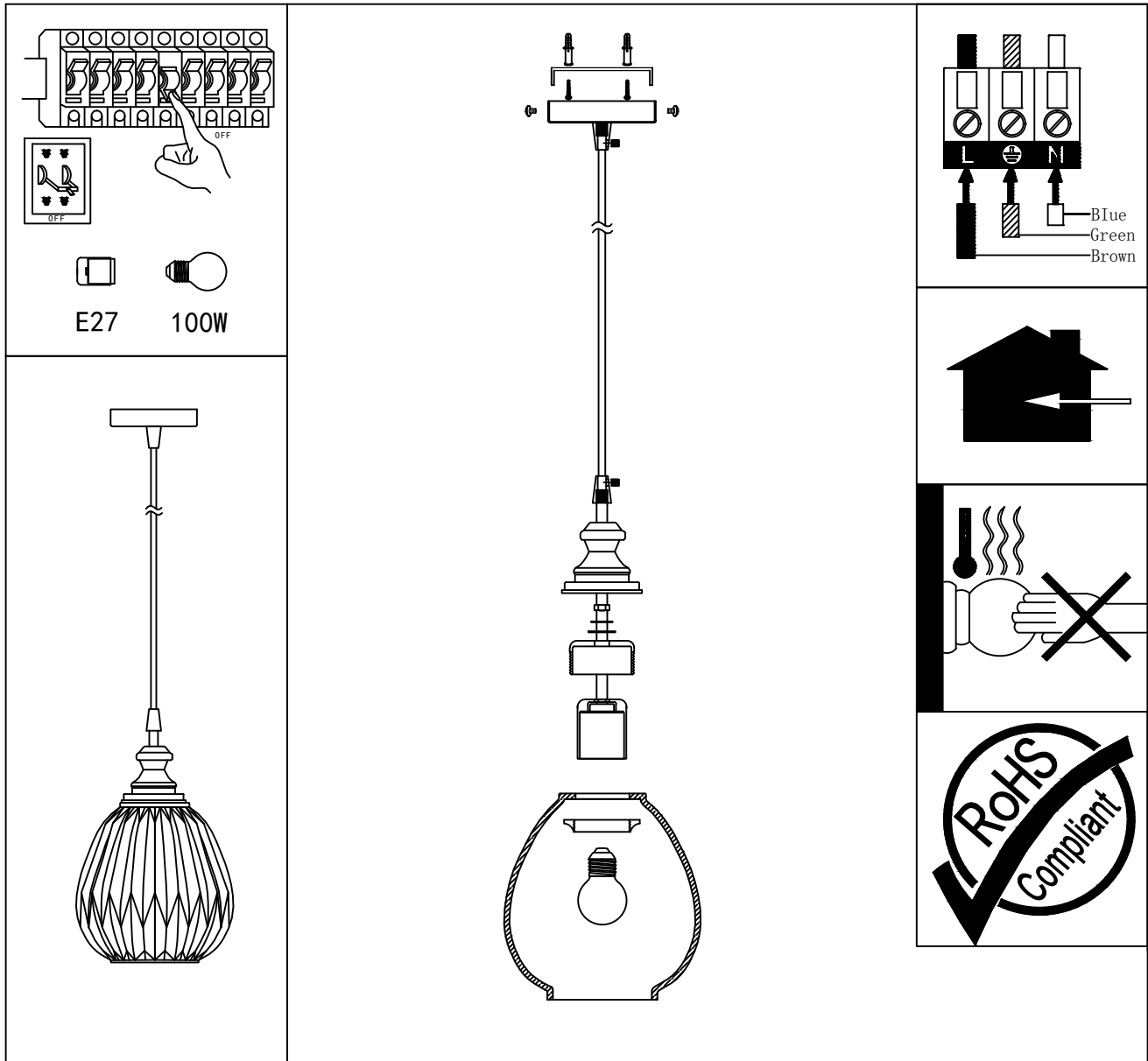

## Installation instruction for this item:

1. Remove the cover and put the lamp on a clean place, then install the lamp;
2. The lamp is limited to used 100W bulb;
3. Fix the lamp body on the wall with the wooden screw;

### Warning:

1. Turn off the main power at the circuit breaker before installing the lamp in order to prevent possible shock;
2. Please wear gloves when installing the lamp;
3. Don't exceed the rated voltage 240V;
4. Don't install on haven't finished wall and loose wood wall;
5. Don't use corrosive liquor to clean it , just as acid liquor and alkaline liquor, please use soft cloth;
6. The lamp is made of glass , installing carefully.