

ENGLISH

Specification of installation

- In order to ensure safety use, please notice the following items
- Read and understand the whole Specification.
- Suitable for the use of 220-240V and 50-60HZ.
- Please wear gloves as installment and avoid rot on the surface of plating.
- Must be installed on the fixed places and be checked annually.
- Please turn off the lighting source by soft cloth as cleaning prohibited to use of rotted detergent.
- Please connect with the local sales service center when there are any abnormality.

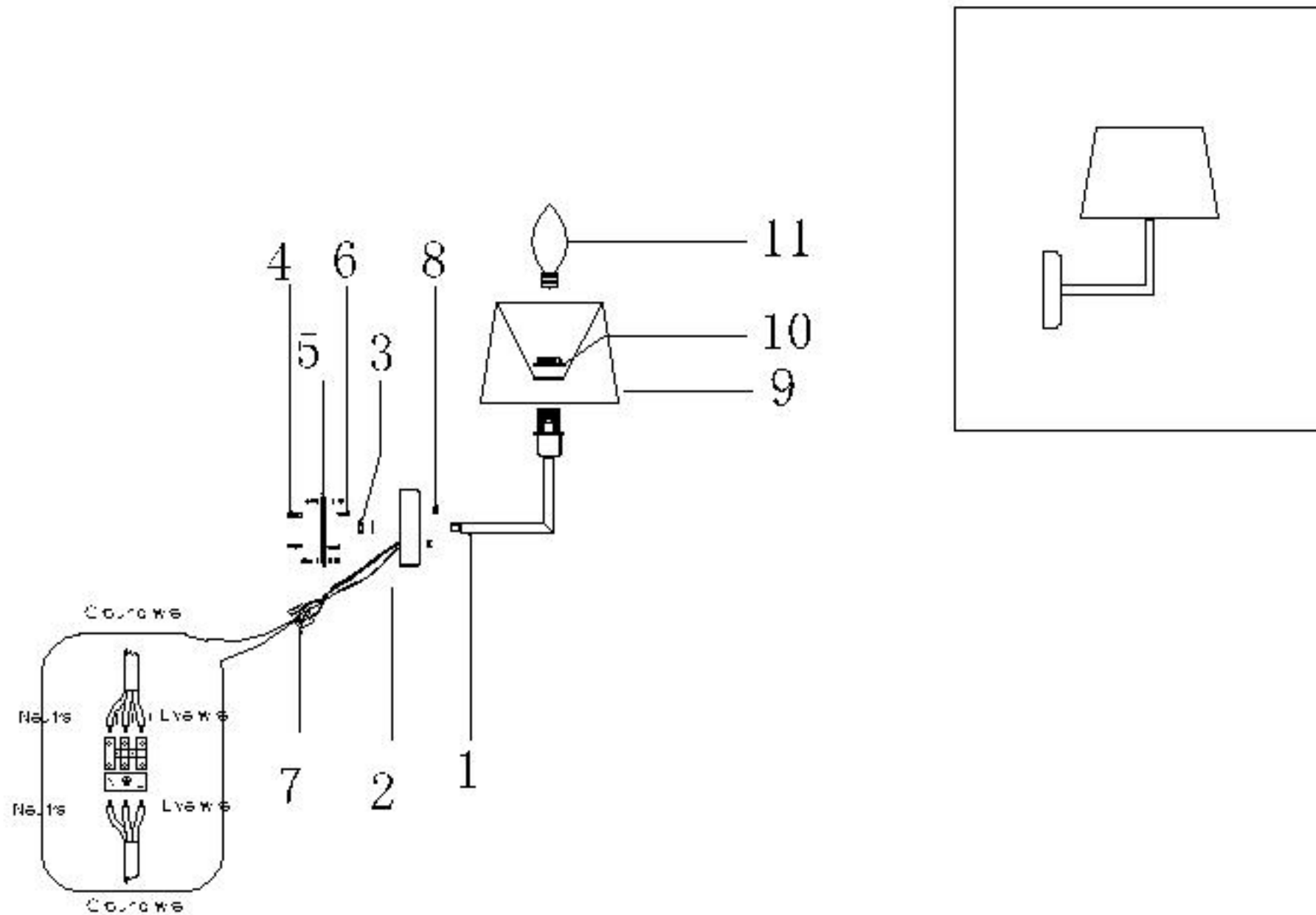

Lamps
Nuts
Screws

- 1 Pipe
- 2 Lamp holder
- 3 Nut
- 4 Wall anchor
- 5 Hangs Taiwan
- 6 Tapping screw
- 7 Terminal
- 8 Nut
- 9 Shade
- 10 Rings
- 11 E14 bulb

Product coding: CONTE AP1

BASE SIZE

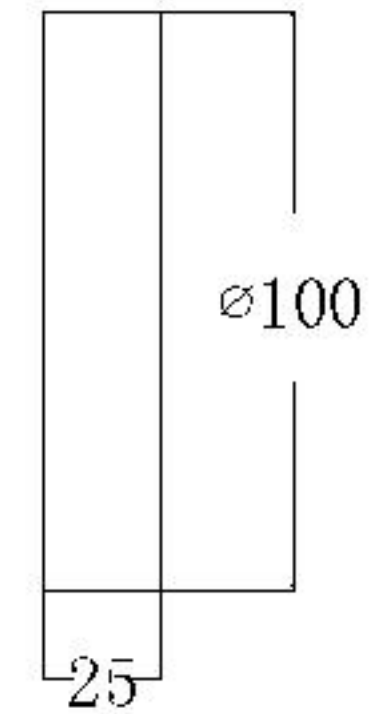

FIXTURE SIZE

